

IMBRIK

Materials

- plywood panel 13 mm or OSB panel 11/12mm
- 10 wood screws $\approx \varnothing 3.5 \times 40 \text{ mm}$

Tools

- hand saw, circular saw, jigsaw
- sander, paper sand...

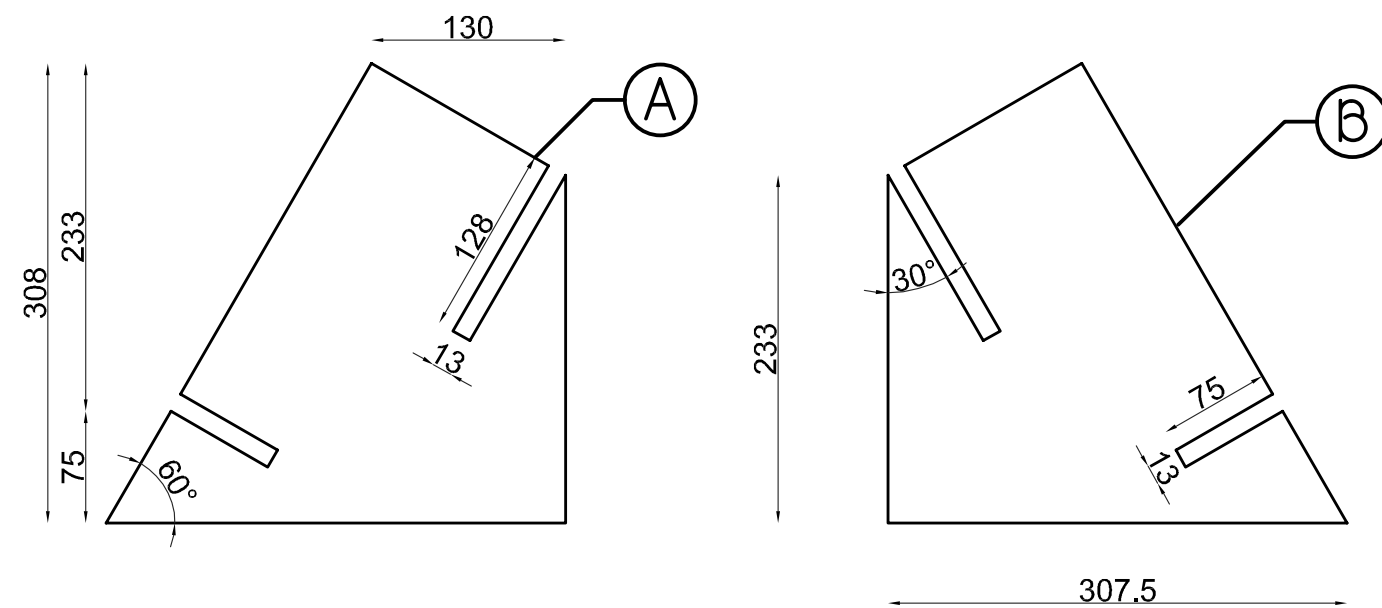
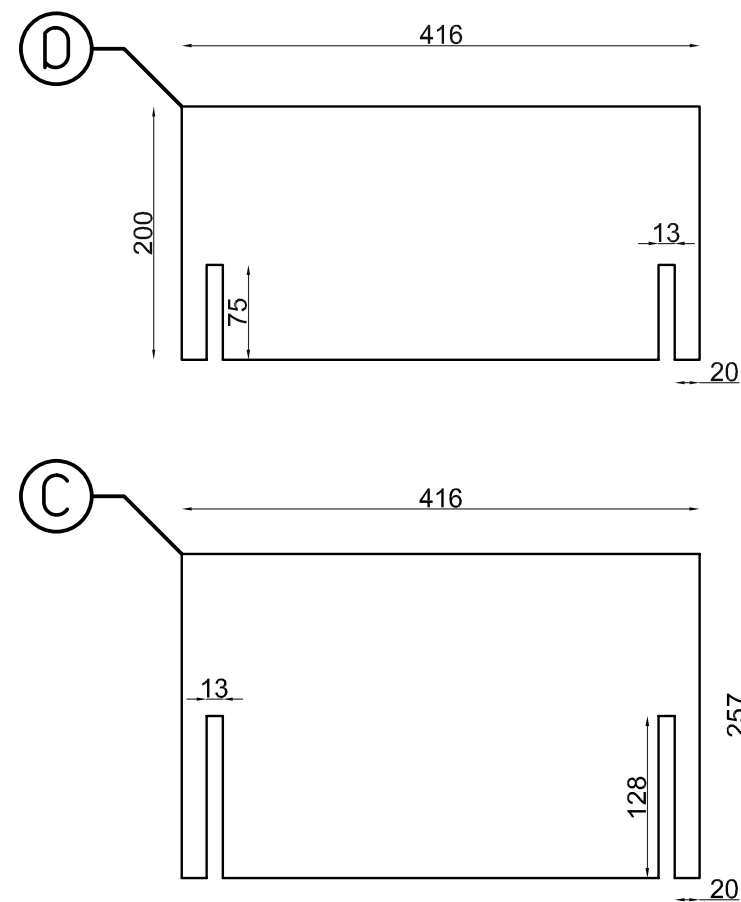

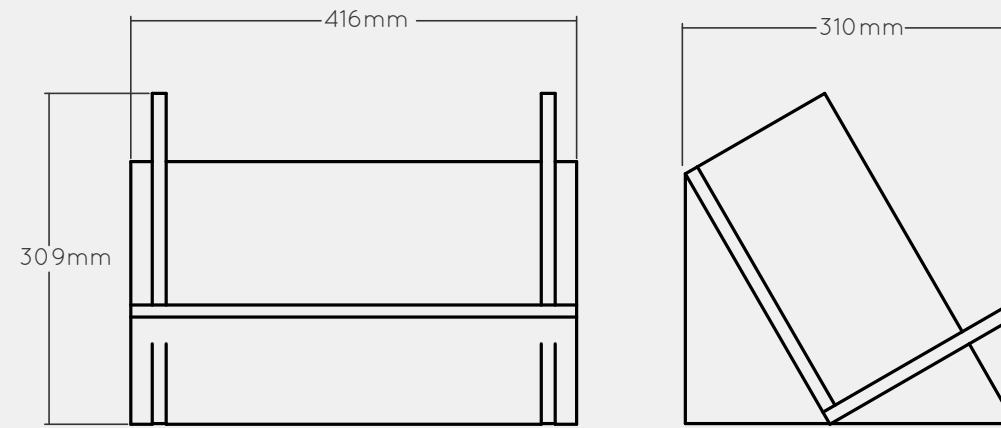
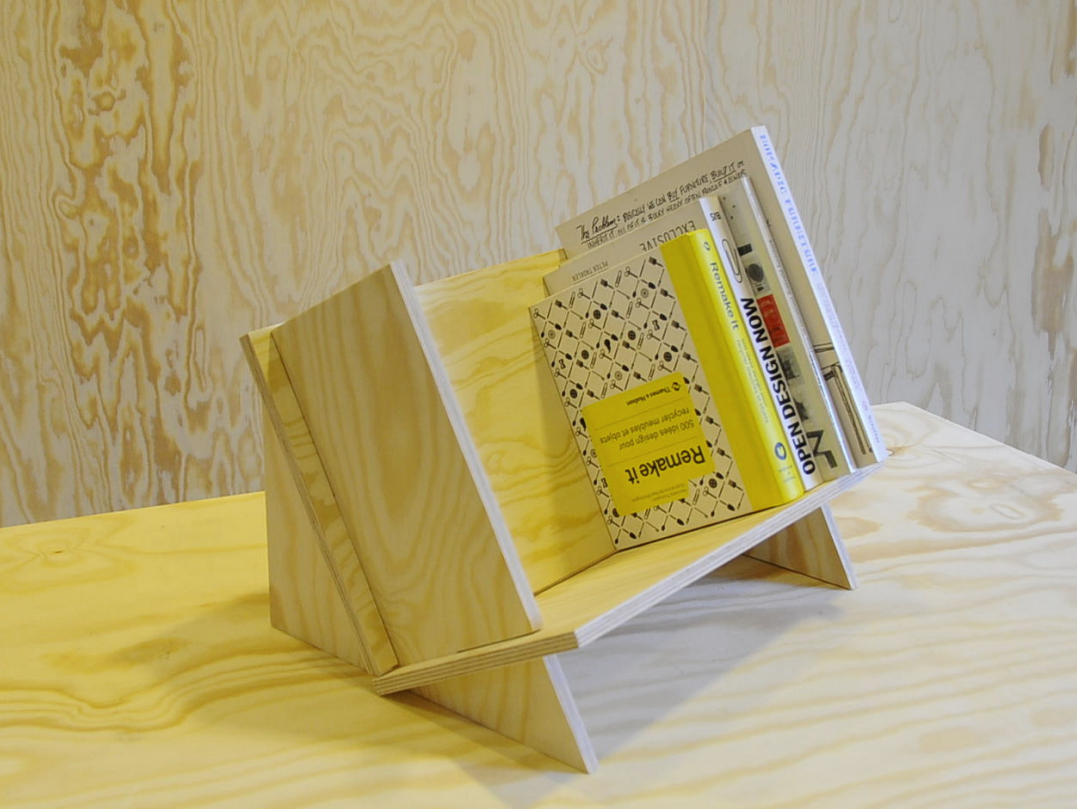

IMBRIK

Building steps

- Sand down all faces and edges first
- Place vertically part A and B
- Drag D part on top slots
- Drag C part on bottom slots
- That's it !

